

ASD OPEN TYPE 6.0/6.4



ASD6.0-6.4/01HE

For installation information please refer to the tooling overview and manuals on our website www.scell-it.com
 Pour les conditions de pose, merci de vous référer à la description de l'outil et aux manuels disponibles sur notre site web.
 Angaben zur Verarbeitung entnehmen Sie bitte der Geräteübersicht und den Betriebsanleitungen auf unserer Website.
 Pro informace ohledně montáže navštivte naše webové stránky nebo nahlédněte do manuálu k nářadí.

ENGLISH	FRANÇAIS	DEUTSCH	CZECH
Mandrel : Steel	Tige : Acier	Dorn : Stahl	trn : Ocel
Body : Aluminium	Corps : Aluminium	Körper : Aluminium	dířík : Hliník
Dome head	Tête plate	Flachrundkopf	plochá hlava

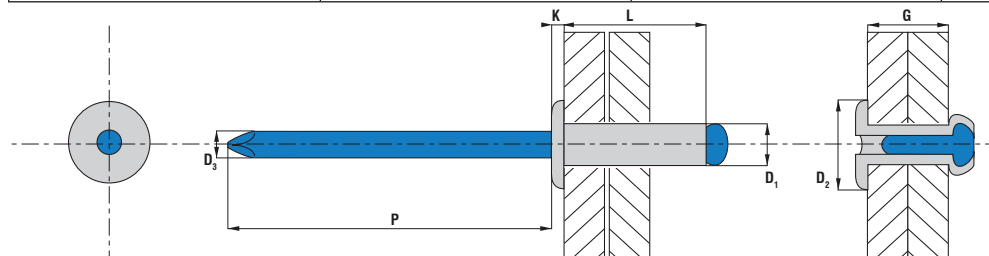

PART NO/REF	D ₁	L	D ₂	K	D ₃	P	G
	Ø (mm)	(mm) +1.0 / -0.2	Ø (mm)	(mm)	Ø (mm)	mini (mm)	min-max (mm)
ASD6008	6.0 +0.08 / -0.15	8.0	12.0 -1.5 / +0.0	1.5 -0.4 / +0.4	3.60	31	2.0-4.0
ASD6010		10.0					4.0-6.0
ASD6012		12.0					6.0-8.0
ASD6016		16.0					9.0-11.0
ASD6018		18.0					11.0-13.0
ASD6022		22.0					13.0-16.0
ASD6026		26.0					16.0-20.0
ASD6030		30.0					20.0-24.0
ASD6035		35.0					24.0-29.0
ASD6410		6.4 +0.08 / -0.15					10.0
ASD6412	12.0		4.0-6.0				
ASD6415	15.0		6.0-9.0				
ASD6418	18.0		9.0-13.0				
ASD6422	22.0		13.0-16.0				
ASD6426	26.0		16.0-20.0				
ASD6430	30.0		20.0-24.0				
ASD6435	35.0		24.0-30.0				
ASD6440	40.0		30.0-35.0				

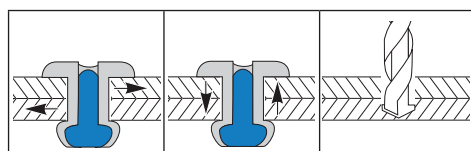

D ₁ (mm)	(N)	(N)	Ø (mm)
6.0	2 400	3 600	6.1
6.4	2 460	4 090	6.5

UNIT PLANT CERTIFICATES



ISO 9001:2000
TS 16949

Scell-it®
Engineering & Development

© 2009 Blue future Intellectual Properties

Data shown are subject to change without prior notice as a result of continuous product development and improvement policy.
Your local Scell-it representative is at your disposal should you need to confirm latest information.