

ASD OPEN TYPE 4.8



ASD4.8FICHE

For installation information please refer to the tooling overview and manuals on our website www.scell-it.com
 Pour les conditions de pose, merci de vous référer à la description de l'outil et aux manuels disponibles sur notre site web.
 Angaben zur Verarbeitung entnehmen Sie bitte der Geräteübersicht und den Betriebsanleitungen auf unserer Website.
 Pro informace ohledně montáže navštivte naše webové stránky nebo nahlédněte do manuálu k nářadí.

ENGLISH	FRANÇAIS	DEUTSCH	CZECH
Mandrel : Steel	Tige : Acier	Dorn : Stahl	trn : Ocel
Body : Aluminium	Corps : Aluminium	Körper : Aluminium	dfik : Hliník
Dome head	Tête plate	Flachrundkopf	plochá hlava

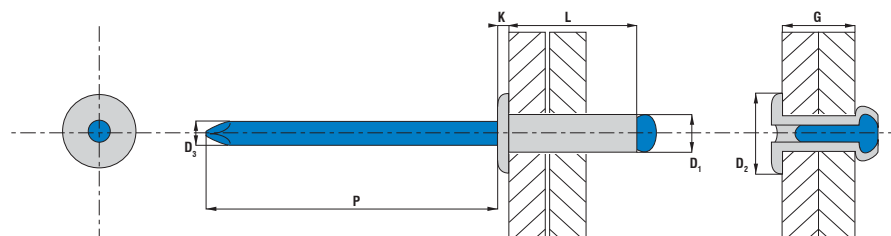

PART NO/REF	D ₁	L	D ₂	K	D ₃	P	G
	Ø (mm)	(mm)+1.0 / -0.2	Ø (mm)	(mm)	Ø (mm)	mini (mm)	min-max (mm)
ASD4806	4.8 +0.08 / -0.15	6.0	9.5 -1.0 / +0.0	1.1 -0.3 / +0.3	2.70	27	1.0-3.0
ASD4808		8.0					3.0-4.5
ASD4810		10.0					4.5-6.0
ASD4812		12.0					6.0-8.0
ASD4814		14.0					8.0-10.0
ASD4816		16.0					10.0-12.0
ASD4818		18.0					12.0-14.0
ASD4820		20.0					14.0-16.0
ASD4822		22.0					16.0-18.0
ASD4825		25.0					18.0-21.0
ASD4830		30.0					23.0-25.0
ASD4835		35.0					25.0-30.0
ASD4840		40.0					30.0-35.0
ASD4845		45.0					35.0-40.0
ASD4850		50.0					40.0-45.0
ASD4860		60.0					45.0-55.0
ASD4870		70.0					55.0-65.0
ASD4880	80.0	65.0-75.0					

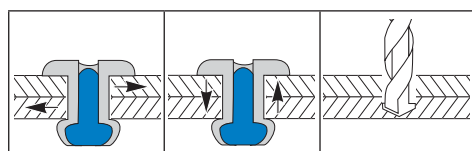

D ₁ (mm)	(N)	(N)	Ø (mm)
4.8	1 580	2 230	4.9

UNIT PLANT CERTIFICATES



ISO 9001:2000
TS 16949

Scell-it®
Engineering & Development

© 2009 Blue future Intellectual Properties

Data shown are subject to change without prior notice as a result of continuous product development and improvement policy.
Your local Scell-it representative is at your disposal should you need to confirm latest information.