

DOUILLES SÉRIE LONGUE

3/4"

mm

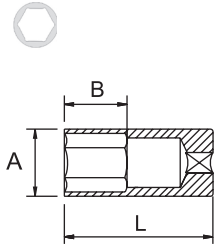

3/4"

Inch.

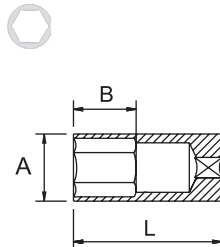

COD x		AF	L	A	B	COUPLE MAXIMAL Nm	gr.		
56900	19			29			300		
56901	21			31			320		
56902	22			32	26	569	360		
56903	23			33			380		10
56904	24			34			400		
56905	26			37		624	420		
56906	27			38		665	420		
56907	29			40	28	751	460		1
56908	30			42		795	510		
56909	32			44		888	560		
56910	34			47		984	610		5
56911	36			50	30	1084	670		
56912	38			52		1200	700		
56913	41			56	34	1353	790		

UNE16501:2009, ISO 1711-1 Cr-V DIN 3124

COD y		AF	L	A	B	COUPLE MAXIMAL Nm	gr.		
56914	3/4"			29			300		
56915	7/8"			32			360		
56916	15/16"			34	26	569	400		10
56917	1"			37		583	410		
56918	1.1/16"			38		665	420		1
56919	1.1/8"			40	28	707	460		
56920	1.1/4"			44		888	560		5
56921	1.3/8"			48	30	1000	640		
56922	1.1/2"			52		1200	700		
56923	1.5/8"			56	34	1353	790		

UNE16501:2009, ISO 1711-1 Cr-V DIN 3124

ADAPTATEUR



COD	1/2"	gr.		
65883	3/4-1"	250	6	1
65886	3/4-1/2"	135		

CLÉ À CLIQUET

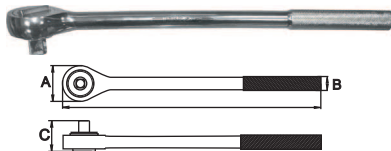

COD	AF	L	A	B	C	gr.		
61859	3/4"	500	69	25	58	2,2	6	

DIN 3122

MANCHE ARTICULÉ



COD	AF	L	Kg.		
61473		1000	3,7		
61456	3/4"	480	1,9	6	

POIGNEE COULISSANTE



COD	AF	L mm	gr.		
61864	3/4"	450	1200	5	

DIN 3122

- x 50% chromée aérospatiale
- 50% polie chromée
- y 100% polie chromée