

DOUILLES 1/2"



**Autant en pouces
qu'en millimètres**

- **6** pans
et **12** pans.



EGA Master offre une large gamme de douilles, autant de série courte comme de série longue, et une grande variété d'articles complémentaires à cela, tels que des adaptateurs, des manches articulés, des rallonges, des clés à cliquet, etc.

Nous disposons de gammes de 1/4", 3/8", 1/2", 3/4" y 1" de carré conducteur de douilles manuelles et de 3/8", 1/2", 3/4", 1", 1.1/2" y 2.1/2" de douilles à choc, étant les seuls du secteur avec une gamme si étendue.

Fabriqués en **chrome-V**, elles sont conçues pour supporter de hauts couples de serrage avec une usure minimum, fournissant une plus grande durée de vie.

DOUILLES

1/2"

mm



COD X	mm	L A B C			COUPLE MAXIMAL Nm	gr.	1
61800	8mm	13			75	48	
61801	9mm	14			95	49	
61802	10mm	15			147	49	
61803	11mm	17			178		
61804	12mm	18			212	50	25
61805	13mm	19			249		
61806	14mm	20			288		
61807	15mm	22			331	55	
61808	16mm	22			377	60	
61809	17mm	24			425	65	20
61810	18mm				477	75	
61811	19mm	26	23		531		
61812	20mm					80	15
61813	21mm	28	24			110	
61814	22mm	30					
61815	23mm						
61816	24mm	32	26	16		115	10
61817	25mm	40					
61818	26mm	41	34	28	18	569	130
61819	27mm	42	36	30			
61820	28mm					20	
61821	29mm	44	38	30		21	8
61822	30mm					22	
61823	32mm	45	42	38	26	210	7

UNE 16501:2009 (ISO 1711-1) Cr-V DIN 3124

- x 50% chromée aérospatiale
- 50% polie chromée
- y 100% polie chromée

GARANTIE A VIE

DOUILLES

1/2"

mm

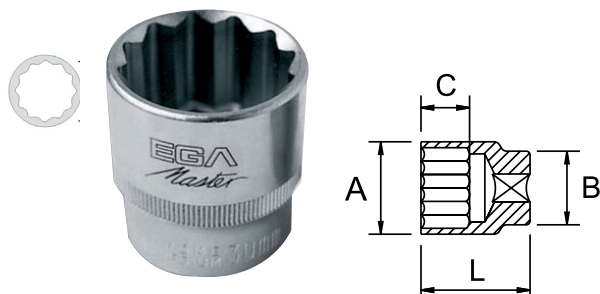

COD X											
61380	8mm		13					75	48		
61381	9mm		14				13	95	48		
61382	10mm		15					147	49		
61383	11mm		17					178			
61384	12mm		18					212			25
61385	13mm		19			22		249	50		
61386	14mm		20					288			
61387	15mm						14	331	55		
61388	16mm	38	22					377	60		
61389	17mm		24					425	65		20
61390	18mm							477	75		
61391	19mm		26	23				531			
61392	20mm		28	24					80		15
61393	21mm					15					
61394	22mm		30						110		
61395	23mm		32	26							
61396	24mm	40				16			115		10
61397	25mm	41	34	28				569			
61398	26mm					18			130		
61399	27mm	42	36								
61400	28mm		38			20			165		8
61401	29mm										
61402	30mm	44	40	32							
61403	32mm	45	42	38	26				210		7

UNE 16501:2009 (ISO 1711-1) Cr-V DIN 3124

1/2"

Inch.



COD X											
60460	5/16"		13					75	46		
60461	3/8"		15				13	147	49		
60462	7/16"		17					178	50		
60463	1/2"		19					249			25
60464	9/16"		20	22				288			
60465	19/32"						14	331	55		
60466	5/8"		22					377			
60459	21/32"	38						425	65		
60467	11/16"		24					477	70		20
60468	3/4"		26	23				531			
60469	25/32"								80		15
60470	13/16"		28	24							
60471	7/8"		30	25					85		
60472	15/16"		32	26		18			95		
60473	31/32"	40	33	28				569	125		10
60474	1"		34						135		
60475	1.1/16"	42	36								
60476	1.1/8"		38	32		19			185		8
60477	1.3/16"		40								
60478	1.1/4"	44	42	34	23				210		7

UNE 16501:2009 (ISO 1711-1) Cr-V DIN 3124

- x 50% chromée aérospatiale
- 50% polie chromée
- y 100% polie chromée

DOUILLES

1/2"

Inch.

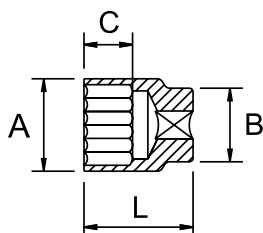

COD X	AF	L	A	B	C	COUPLE MAXIMAL Nm	gr.		
60480	5/16"		13			75	46		
60481	3/8"		15		13	147	49		
60482	7/16"		17			178	50		
60483	1/2"		19			249		25	
60484	9/16"		20	22		288			
60485	19/32"		22		14	331	55		
60486	5/8"	38				377			
60479	21/32"		24			425	65		
60487	11/16"		26	23		477	70	20	
60488	3/4"		28	24		531	80		1
60489	25/32"		30	25			85	15	
60490	13/16"		32	26	18		95		
60491	7/8"		33				125		
60492	15/16"	40	34	28		569	135	10	
60494	1"		36						
60495	1.1/16"	42	38	32	19		185		8
60496	1.1/8"		40		22				
60497	1.3/16"	44	42	34	23		210	7	
60498	1.1/4"								

UNE 16501:2009 (ISO 1711-1) Cr-V DIN 3124

SÉRIE LONGUE

1/2"

mm

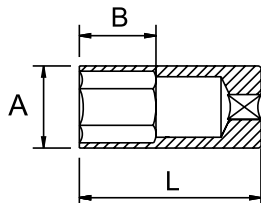

COD X		L	A	B	COUPLE MAXIMAL Nm	gr.			
65044	10mm		16		147	110			
65045	11mm		17		178				
65046	12mm		18	22	212				
65047	13mm		19		249	115			
65048	14mm		21		288				
65049	15mm		22		331				
65050	16mm		24	26	377	125			
65051	17mm		26		425	130			
65052	18mm		28		477	150			
65053	19mm	75	30		531	165		10	1
65054	21mm		32			180			
65055	22mm		34			210			
65056	23mm		36	32		240			
65057	24mm		38			260			
67770	26mm		40		569	330			
67771	27mm		42			350			
67772	28mm					380			
67773	29mm					420			
67774	30mm					460			
67775	32mm								

UNE 16501:2009 (ISO 1711-1) Cr-V DIN 3124

- x 50% chromée aérospatiale
- 50% polie chromée
- y 100% polie chromée

SÉRIE LONGUE

1/2"

mm

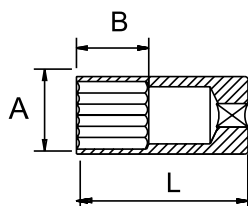

COD X		L	A	B	COUPLE MAXIMAL Nm	gr.		
67780	10mm		16		147	110		
67781	11mm		17		178			
67782	12mm		18		212			
67783	13mm		19	22	249	115		
67784	14mm		21		288			
67785	15mm		22		331	125		
67786	16mm		22	26	377			
67787	17mm		24		425	130		
67788	18mm		26		477	150		
67789	19mm	75	26		531	165	10	1
67791	21mm		28			180		
67792	22mm		30			210		
67793	23mm		32	32		240		
67794	24mm		32			260		
67795	26mm		36		569	330		
67796	27mm		36			350		
67797	28mm		38			380		
67798	29mm		40			420		
67799	30mm		40			420		
67800	32mm		42			460		

UNE 16501:2009 (ISO 1711-1) Cr-V DIN 3124

1/2"

Inch.

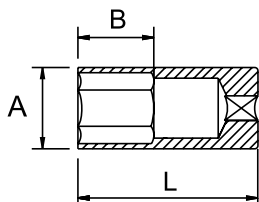

COD y		L	A	B	COUPLE MAXIMAL Nm	gr.		
65064	3/8"		15	24	147	105		
65065	7/16"		17		178	115		
65066	1/2"		19	27	249			
65067	9/16"		21		288	120		
65068	5/8"	75	22		377		10	1
65069	11/16"		24		477	125		
65070	3/4"		26	34	531	150		
65071	13/16"		27			170		
65072	7/8"		30		569	210		
65073	15/16"		32			250		

UNE 16501:2009 (ISO 1711-1) Cr-V DIN 3124

1/2"

Inch.

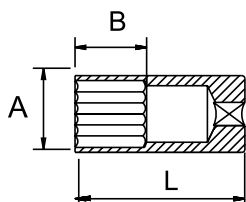

COD y		L	A	B	COUPLE MAXIMAL Nm	gr.		
67805	3/8"		15		147	105		
67806	7/16"		17	24	178	115		
67807	1/2"		19	27	249			
67808	9/16"		21		288	120		
67809	5/8"	75	22		377		10	1
67810	11/16"		24		477	125		
67811	3/4"		26		531	150		
67812	13/16"		27	34		170		
67813	7/8"		30			210		
67814	15/16"		32			250		
67815	1"		34		569	280		
67816	1.1/16"		36			330		
67817	1.1/8"		38			370		
67818	1.1/4"		38			455		

UNE 16501:2009 (ISO 1711-1) Cr-V DIN 3124

- x 50% chromée aérospatiale
- 50% polie chromée
- y 100% polie chromée

SPLINE

1/2"

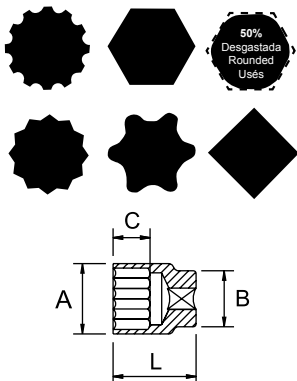

COD y	AF	AF	TX	L	A	B	C	COUPLE MAXIMAL Nm	gr.	1
55795	-	-	10mm	-	15,5			147	47	
55811	-	3/8"	-	-				178	48	
55796	M14	7/16"	11mm	E14	17			212		25
55797	M15	-	12mm	E16	18			249	50	
55798	M16	1/2"	13mm	-	19	22	14	288		
55799	M18	-	14mm	E18	21			331		
55800	-	-	15mm	-				377	65	
55801	M20	5/8"	16mm	E20	38	24		425	60	20
55802	-	-	17mm	-				477	75	
55803	M22	-	18mm	E22	26	23		531	60	1
55804	M24	3/4"	19mm	E24				80	15	
55805	M25	-	20mm	-	28	24		70		
55806	M26	13/16"	21mm	-	30	26	17	85		
55807	M28	7/8"	22mm	-				95	10	
55808	M30	15/16"	24mm	-	32	28	19	115		
55833	-	1"	-	-	40	34		140		
55809	M34	1.1/16"	27mm	-	42	36	32	155	8	
55834	-	1.1/8"	-	-	43	38		180		
55810	M38	1.3/16"	30mm	-	44	40	35			

UNE 16501:2009 (ISO 1711-1) Cr-V DIN 3120

EXTRACTEUR D'ÉCROUS USÉS JUSQU'À 50%

1/2"

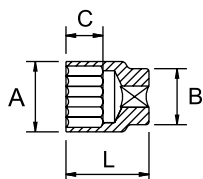

COD y	AF	L	A	B	C	COUPLE MAXIMAL Nm	gr.	1
55795	10mm	15,5				147	47	
55796	11mm	17				178	48	
55797	12mm	18				212		25
55798	13mm	19	22		14	249	50	
55799	14mm	21				288		
55800	15mm					331		
55801	16mm	38	24			377	65	
55802	17mm					425	60	20
55803	18mm		26	23		477	75	
55804	19mm					531	60	1
55805	20mm		28	24		80	15	
55806	21mm				17	70		
55807	22mm		30	26		85		
55808	24mm		32	28		95	10	
55809	27mm	42	36	32	20	140		8
55810	30mm	44	40	35	22	180		

UNE 16501:2009 (ISO 1711-1) Cr-V DIN 3120

ADAPTATEUR



COD	1/2"	gr.		
65885	1/2-3/8"	50	6	1
65882	1/2-3/4"	125	6	1

DOUILLES POUR BOUGIES

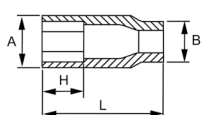

COD	1/2"	gr.						
61462	16mm	22	22	14	65	100	6	1
61463	21mm	28	24	16	65	150	6	1

MANCHE ARTICULÉ



COD	1/2"	gr.		
61441	0 - 180°	390 mm	650	

MANCHE ARTICULÉ ACTION RAPIDE



COD	1/2"	gr.		
61483	470 mm	900	5	

MANCHE ARTICULÉ TÉLESCOPIQUE

Fabriqué en acier au CR-V

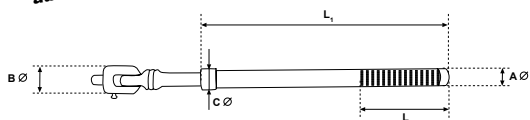

COD	1/2"	gr.								
61484	180°	430	650	305	110	21,5	33	25	1150	5

RALLONGE

Fabriqué en acier au CR-V

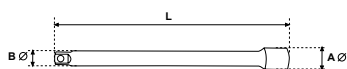

COD	1/2"	gr.				
61453	3"	75 mm	135			
61455	5"	125 mm	22 mm	15,5mm	220	5
61458	10"	250 mm	370			

DIN 3123

VILLEBREQUIN

Fabriqué en acier au CR-V

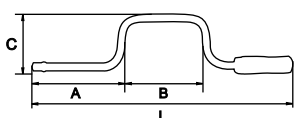

COD	1/2"	gr.				
61434	410 mm	90 mm	12 mm	550	5	

DIN 3122

CLÉ À CLIQUET

Fabriqué en acier au CR-V

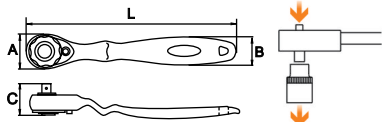

COD	□	∇	←L→	←A→	←B→	←C→	gr.	▢	🏠
61430	1/2"	5°	230	39	31	45	550	6	1

Cliquet de friction

DIN 3122

Fabriqué en acier au CR-V

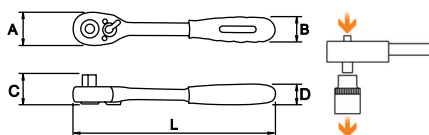

COD	□	∇	←L→	←A→	←B→	←C→	←D→	gr.	▢	🏠
61431	1/2"	9°	250	37	32	37	28	550	6	1

40 Dents

DIN 3122

Fabriqué en acier au CR-V

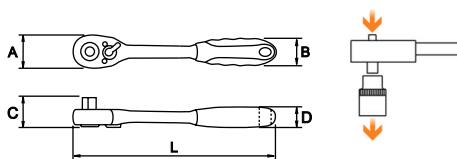

COD	□	∇	←L→	←A→	←B→	←C→	←D→	gr.	▢	🏠
62606	1/2"	7,5°	250	42	36	37	28	560	6	1

48 Dents

DIN 3122

POIGNEE COULISSANTE

Fabriqué en acier au CR-V

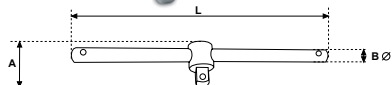

COD	□	←L→	←A→	←B→	gr.	▢	🏠
61440	1/2"	250 mm	42 mm	13 mm	160	5	1

DIN 3122

CARDAN UNIVERSEL

Fabriqué en acier au CR-V



COD	□	←L→	←A→	gr.	▢	🏠
61437	1/2"	71,5 mm	25 mm	140	10	1

CARACTÉRISTIQUES TECHNIQUES







MATÉRIEL	Cr-V
DURETÉ MINIMUM	39 HRC



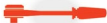

JEUX

1/2"





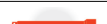

19pcs





COD			Kg. 
55668	M12, M14, M15, M16, M18, M20, M22, M24, M25, M26, M28, M30, M34, M38		3,5
	Carraca		●
	Alargadera		5"-10"
	Mango en T		●
	Articulación universal		●

COD			Kg. 
55599	8-9-10-11-12-13-14-15-16-17-18-19-21-22-23-24mm		2,95
	Cliquet		●
	Rallonge		5"-10"
	Cardan Universel		●





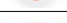

20pcs

COD			Kg. 
55600	8-9-10-11-12-13-14-15-16-17-18-19-21-22-23-24mm		2,95
	Cliquet		●
	Rallonge		5"-10"
	Cardan Universel		●

21pcs

COD			Kg. 
55601	10-11-12-13-14-15-16-17-18-19-21-22-24-27-30-32mm		3,5
	Cliquet		●
	Rallonge		5"-10"
	T Poignée		●
	Cardan Universel		●

25pcs

COD			Kg. 
61960	10-11-12-13-14-15-16-17-18-19-20-21-22-23-24-26-27-28-30-32mm		4,2
61963	5/16"-3/8"-7/16"-1/2"-9/16"-19/32"-5/8"-21/32"-11/16"-3/4"-25/32"-13/16"-7/8"-15/16"-31/32"-1"-1.1/16"-1.1/8"-1.3/16"-1.1/4"		
	Cliquet		●
	Rallonge		5"-10"
	T Poignée		●
	Cardan Universel		●

JEUX

1/2"



25pcs

COD			Kg.
55602	10-11-12-13-14-15-16-17-18-19-20-21-22-23-24-25-26-27-28-30-32mm		3,5
	Cliquet		●
	Rallonge		5"
	T Poignée		●
	Cardan Universel		●



28pcs

COD			Kg.
55597	8-9-10-11-12-13-14-15-16-17-18-19-21-22-23-24-26-27-28-29-30-32mm		5,35
	Cliquet		●
	Rallonge		5"-10"
	T Poignée		●
	Cardan Universel		●
	Villebrequin		●



28pcs

COD			Kg.
55598	8-9-10-11-12-13-14-15-16-17-18-19-21-22-23-24-26-27-28-29-30-32mm		5,35
	Cliquet		●
	Rallonge		5"-10"
	T Poignée		●
	Cardan Universel		●
	Villebrequin		●



35pcs

COD			Kg.
55603	10-11-13-14-17-19-22-24-27-30-32mm 5/16"-3/8"-7/16"-1/2"-9/16"-19/32"-5/8"-21/32"-11/16"-3/4"-25/32"-13/16"-7/8"-15/16"-1"-1.1/16"-1.1/8"-1.3/16"-1.1/4"		5,7
	Cliquet		●
	Rallonge		5"-10"
	Cardan Universel		●
	Villebrequin		●

JEUX







1/2"



17pcs





COD		Kg.
61796	10-11-12-13-14-15-16-17-18-19-20-22-24-27-30-32mm	2,0
61798	5/16"-3/8"-7/16"-1/2"-9/16"-5/8"-11/16"-3/4"-13/16"-7/8"-15/16"-1"-1.1/16"-1.1/8"-1.3/16"-1.1/4"	
(AF) $\begin{matrix} \perp \\ c \\ \top \end{matrix}$		
61797	10-11-12-13-14-15-16-17-18-19-20-22-24-27-30-32mm	2,0
61799	5/16"-3/8"-7/16"-1/2"-9/16"-5/8"-11/16"-3/4"-13/16"-7/8"-15/16"-1"-1.1/16"-1.1/8"-1.3/16"-1.1/4"	
(AF) $\begin{matrix} \perp \\ c \\ \top \end{matrix}$		
	Cliquet 	●

41pcs

COD		Kg.
61793	10-11-12-13-14-15-16-17-18-19-20-21-22-23-24-27-30-32mm 3/8"-7/16"-1/2"-9/16"-5/8"-11/16"-3/4"-13/16"-7/8"-15/16"-1"-1.1/16"-1.1/8"-1.3/16"-1.1/4"	5,5
(AF) $\begin{matrix} \perp \\ c \\ \top \end{matrix}$		
	Cliquet 	●
	Rallonge 	6"-8"
	T Poignée 	●
	Cardan Universel 	●
	Manche articulé 	●
	Douilles pour bougies 	16-21mm



33pcs

COD		Série Longue	Kg.
65074	10-11-12-13-14-15-16-17-18-19-20-21-22-23-24mm	10-11-12-13-14-15-16-17-18-19mm	7,0
65075	3/8"-7/16"-1/2"-9/16"-5/8"-11/16"-3/4"-13/16"-7/8"-15/16"-1"-1.1/16"-1.1/8"-1.3/16"-1.1/4"	3/8"-7/16"-1/2"-9/16"-5/8"-11/16"-3/4"-3/16"-7/8"-15/16"	
(AF) $\begin{matrix} \perp \\ c \\ \top \end{matrix}$ (AF) $\begin{matrix} \perp \\ c \\ \top \end{matrix}$			
	Cliquet 		●
	Rallonge 		3"-5"-10"
	Manche articulé 		●
	Cardan Universel 		●
	Douilles pour bougies 		16-21mm(65074) 5/8"-13/16"(65075)



PRESENTOIRS

1/2"



233pcs

UN.	COD:65296
	8mm
	9mm
	10mm
12	11mm
	12mm
	13mm
	14mm
	15mm
11	16mm
	17mm
10	18mm
	19mm
9	20mm
	21mm
	22mm
8	23mm
	24mm
	25mm
	26mm
7	27mm
	28mm
	29mm
	30mm
6	32mm



UN.	COD:65297
	8mm
	9mm
	10mm
12	11mm
	12mm
	13mm
	14mm
	15mm
11	16mm
	17mm
10	18mm
	19mm
9	20mm
	21mm
	22mm
8	23mm
	24mm
	25mm
	26mm
7	27mm
	28mm
	29mm
	30mm
6	32mm



236pcs

UN.	COD:65298
24	5/16"
	3/8"
12	7/16"
	1/22
24	9/16"
22	5/8"
20	11/16"
19	3/4"
9	13/16"
16	7/8"
8	15/16"
14	1"
7	1.1/16"
	1.1/8"
	1.3/16"
6	1.1/4"

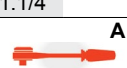

UN.	COD:65299
24	5/16"
	3/8"
	7/16"
12	1/22
	9/16"
	19/32"
11	5/8"
	21/32"
20	11/16"
10	3/4"
9	25/32"
	13/16"
16	7/8"
8	15/16"
	31/32"
7	1"
	1.1/16"
	1.1/8"
	1.3/16"
6	1.1/4"

